



MOZ DIVIDER SYSTEMS

Technical Information

DIVIDER CLASSIFICATIONS

CLASSIC DIVIDERS

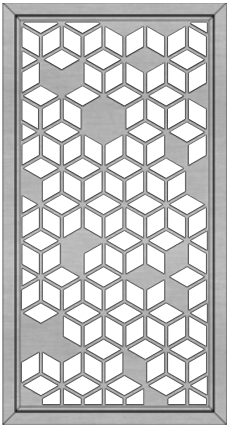

ARTESSA
Full-Frame Metal Divider with Single Panel Infill

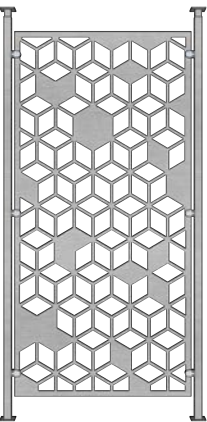

VERTENZA
Post Mounted Metal Divider System with mounting options:
Grip – Secure, clean fit
Angle – Minimal hardware
Direct – Exposed fasteners

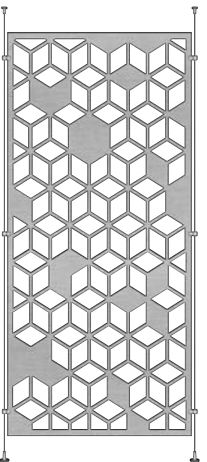

TENSURA
Cable-Suspended Divider with Minimal Grippers

DIVIDER CLASSIFICATIONS

DIMENSIONAL DIVIDERS

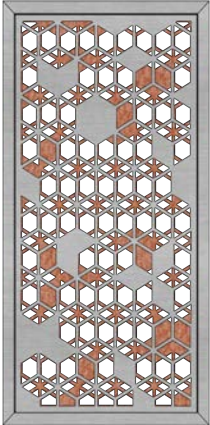

ARTESSA DULO
Full-Frame Divider with Dual-Layer Panels and Concealed Mounting

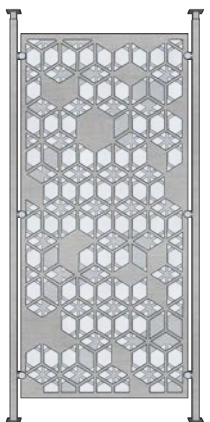

VERTENZA TRILO
Post-Mounted Divider with Triple-Layer Panels and Gripper Mounts

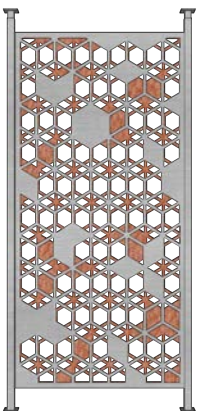

VERTENZA DULO
Post-Mounted Divider with Dual-Layer Panels and Concealed Channel Mounting

Frame with single panel includes:

Panels, welded frame, perimeter angles, panel fasteners. Mounting holes provided for floor-to-ceiling attachment.

Panel Size:

4'x8' Standard size (*max 4'x10'*)

Material options:

3/16" Laser Cut Aluminum

1/8" Perforated Aluminum (*with solid margins*)

.090" Solid Aluminum

.090" Engravings Aluminum (*single sided only*)

Interior applications only**Mounting & Support:****Frame:**

3"x3" Welded frame (*Painted in a complementary color*).
Anchored floor to ceiling in the field.
Shimming may be required.

Panel Attachment:

Angles fasten panel to the front/back perimeter of the frame.

(*Angles and fasteners painted in a complementary color*)

Custom options:

•**Continuous Framed Panels:** Choose a slimmer 1.5" x 3" frame for a seamless, uninterrupted appearance.

•**Freestanding** - Max height 30"; anchors every 16".
(*Decorative use only—not suitable for guardrails or balconies*)

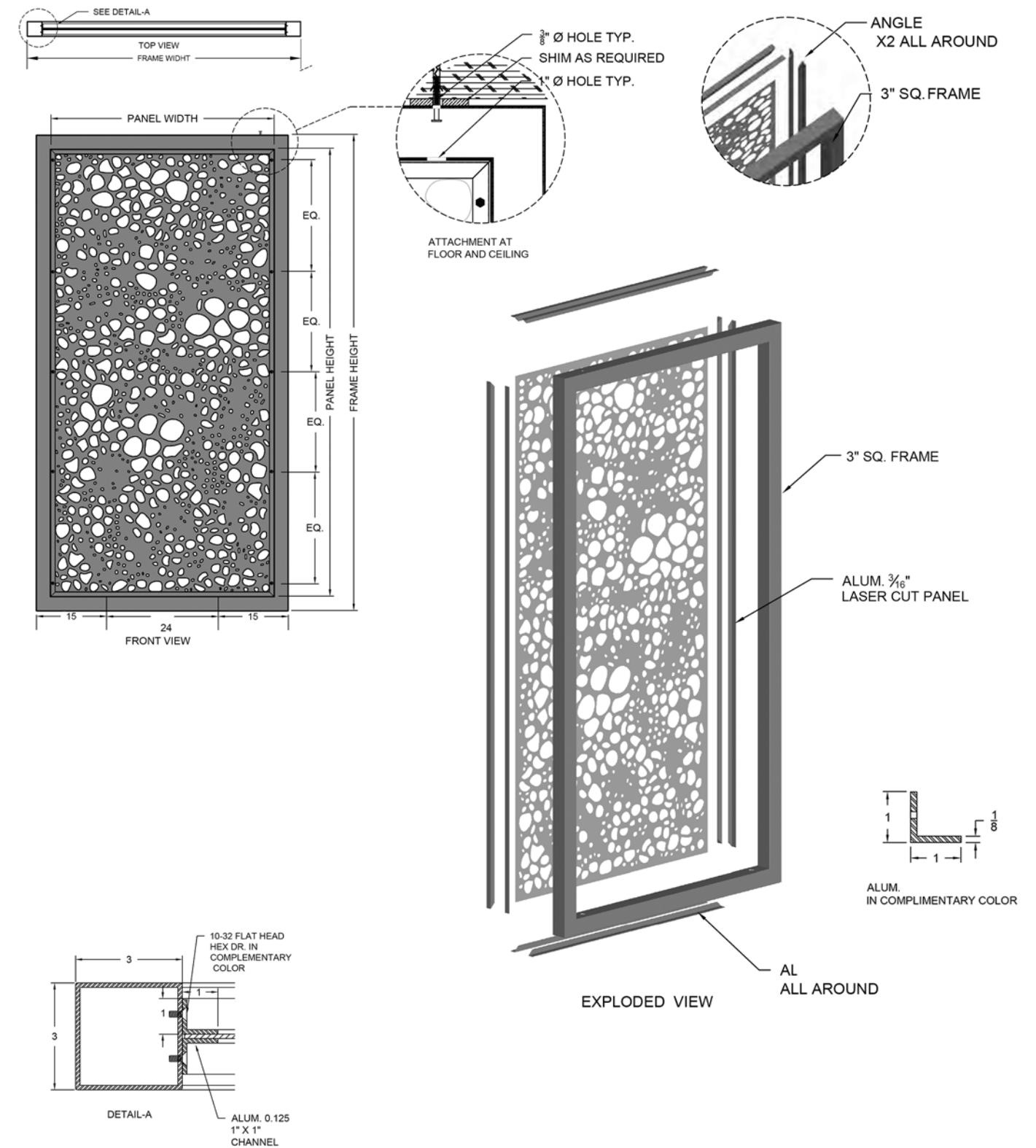
**Installation notes:**

Fasteners and mounting substrate to be provided by others.

Install on a straight, flat surface for best performance and alignment.

ARTESSA DULO

Frame with two panels includes:

Two panels, welded frame with pre-mounted channels, panel fasteners. Mounting holes provided for floor-to-ceiling attachment.

Panel Size:

4'x8' Standard size (max 4'x10')

Material options:

3/16" Laser Cut Aluminum
1/8" Perforated Aluminum (with solid margins)
.090" Solid Aluminum
.090" Engravings Aluminum (single sided only)

Design Flexibility:

Front and back panels can match or contrast—choose to flip, rotate, or mix materials for a dynamic, dimensional look.

Interior applications only

Mounting & Support:

Frame:

3"x3" Welded frame (painted in a complementary color)
Anchored floor to ceiling in the field.
Shimming may be required.

Channel Mounting:

1" x 1" U-channels attach panels with visible fasteners.

(All components painted to coordinate with the frame).

Custom options:

- Continuous Framed Panels: Choose a slimmer 1.5" x 3" frame for a seamless, uninterrupted appearance.
- Lighting Integration: Optional edge lighting at left and right sides.
- Freestanding - Max height 30"; anchors every 16".
(Decorative use only—not suitable for guardrails or balconies)

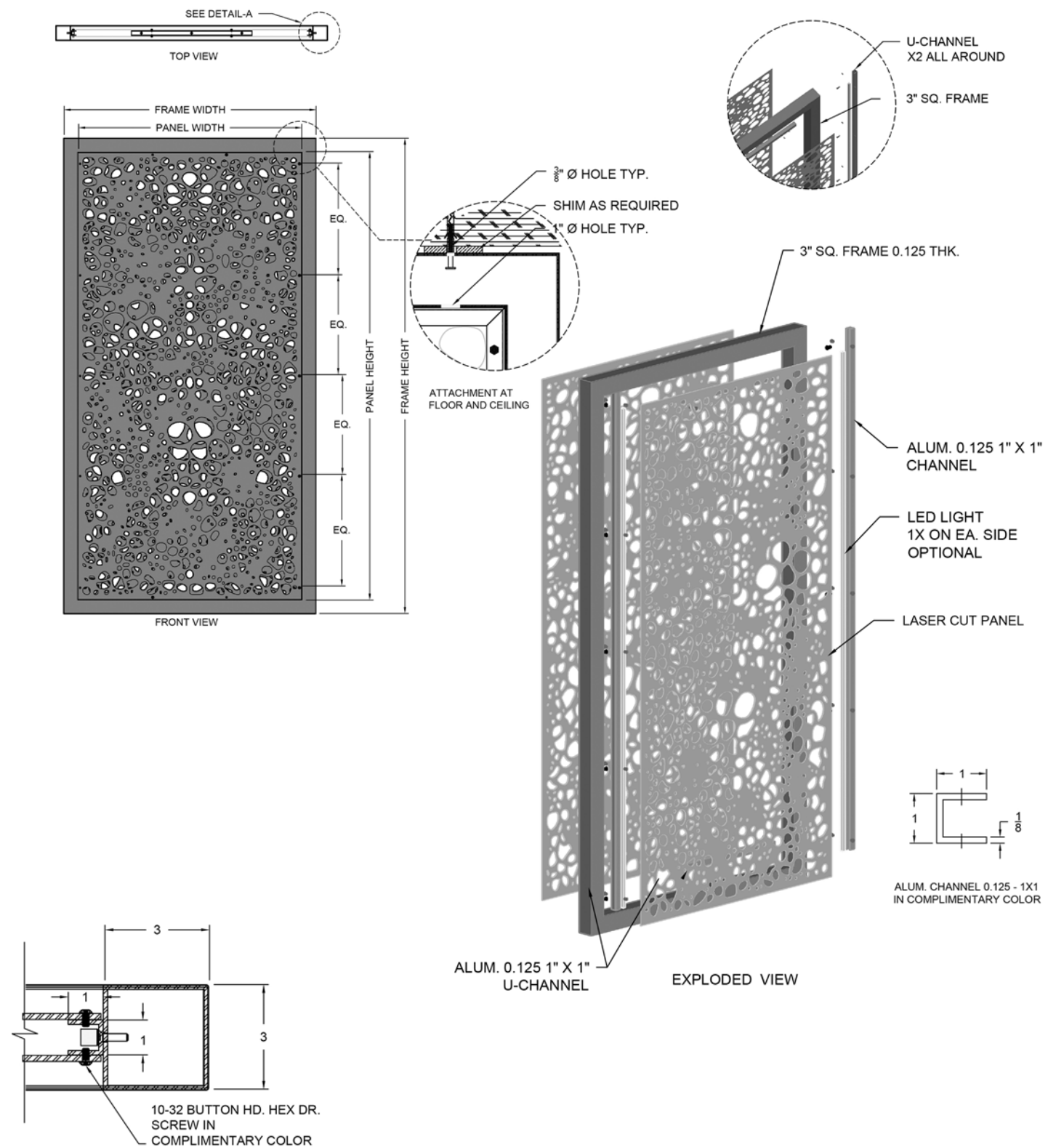
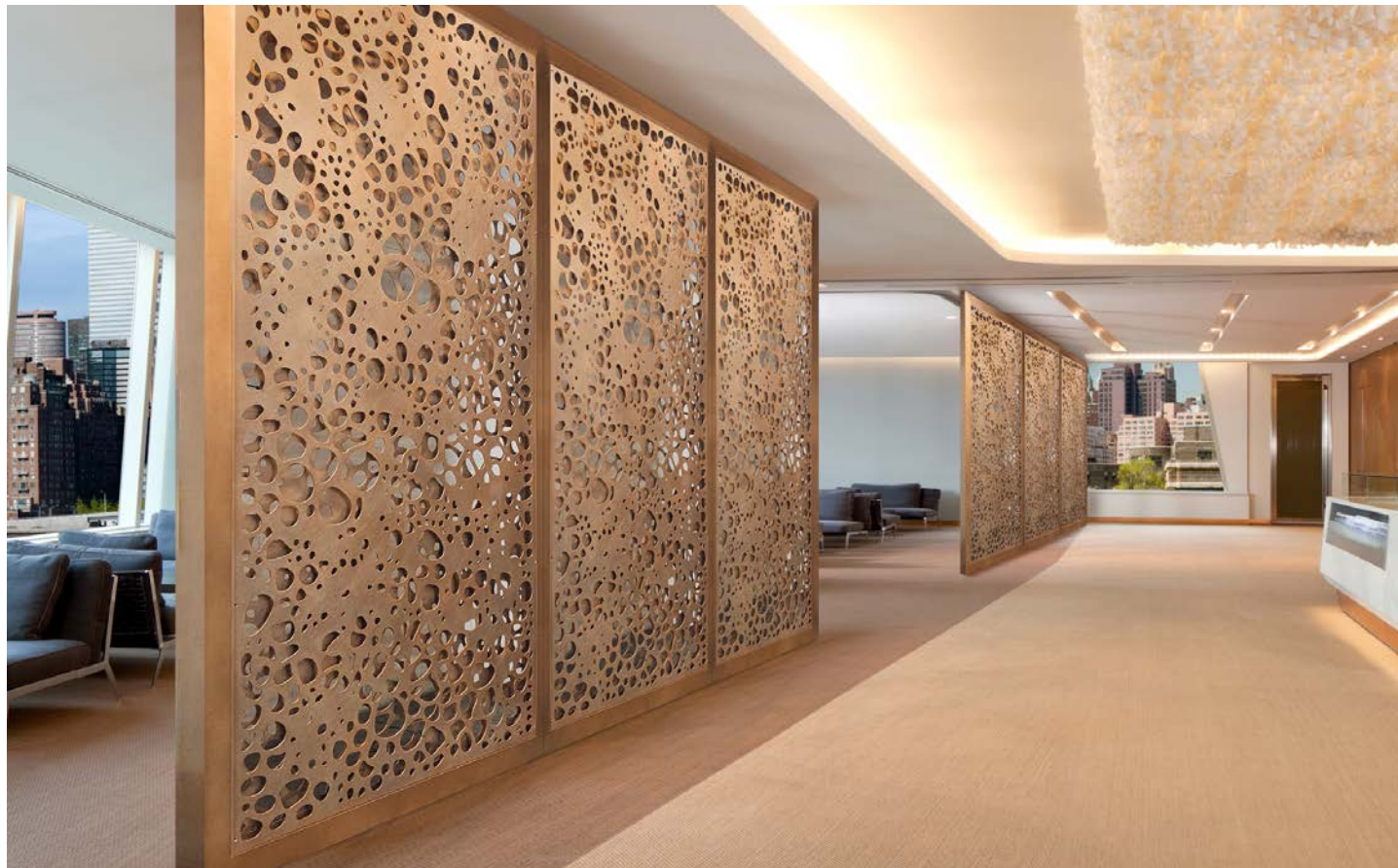

Installation notes:

Fasteners and mounting substrate to be provided by others.
Install on a straight, flat surface for best performance and alignment.

VERTENZA GRIP

Posts with Grippers includes:

Panels, panel grippers, posts, mounting plates for floor and ceiling attachment.

Panel Size:

4'x8' Standard size (*max 4'x10'*)

Material options:

3/16" Laser Cut Aluminum

1/8" Perforated Aluminum (*with solid margins*)

.090" Solid Aluminum

.090" Engravings Aluminum (*single sided only*)

Suitable for interior & exterior applications

Mounting & Support:**Posts:**

2" square aluminum posts in Brushed Clear finish with 4" square base plates (*floor and ceiling*).

Standard post height up to 12'.

Panel Grippers:

Brushed stainless finish, supports material up to 1/4" thick.

4' x 8' panels require 6 grippers.

4' x 10' panels require 8 grippers.

Custom options:

- Round post profile
- Painted posts and grippers in a complementary color
- Freestanding option available (*some movement or flexibility expected*).

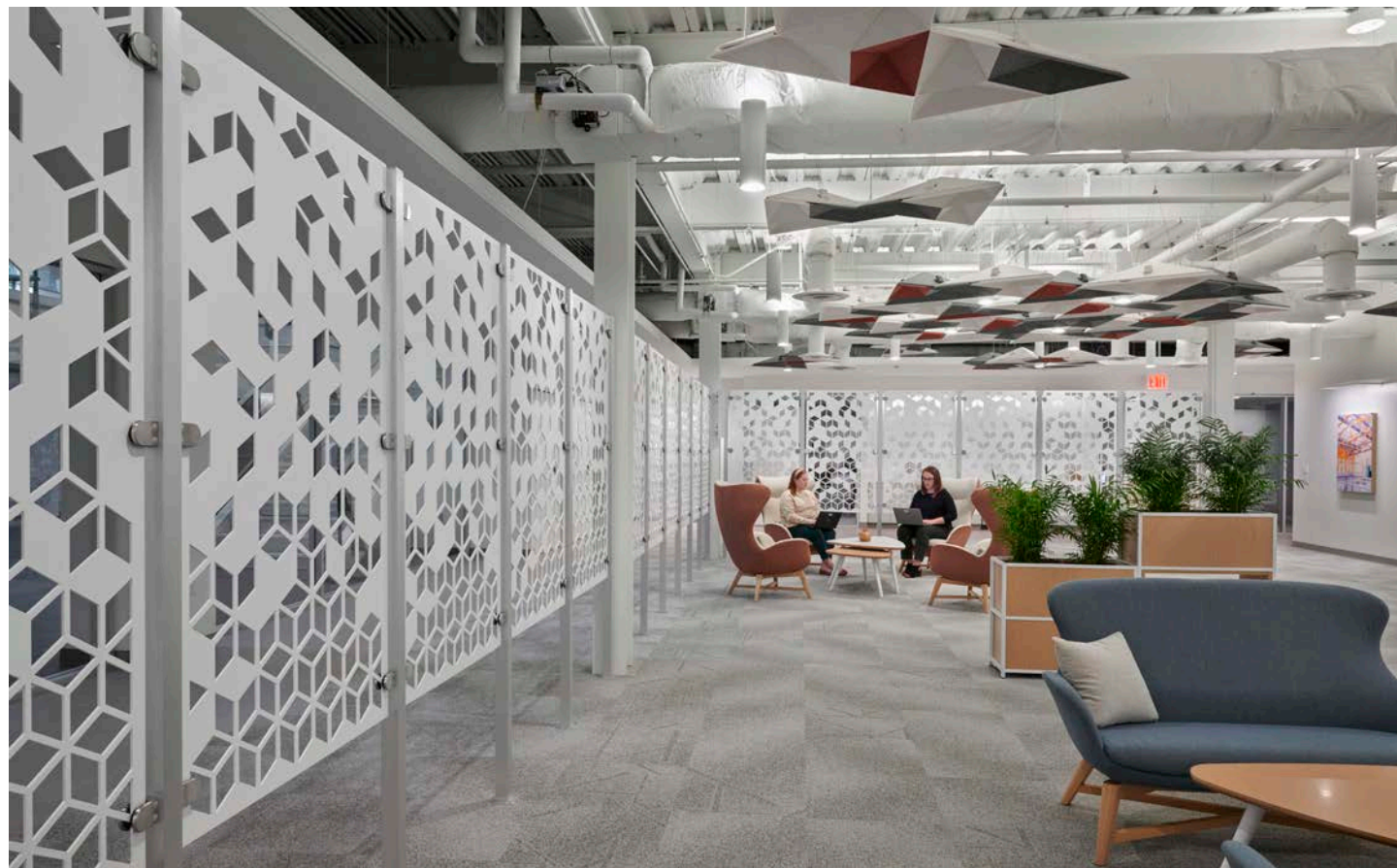

VERTENZA GRIP

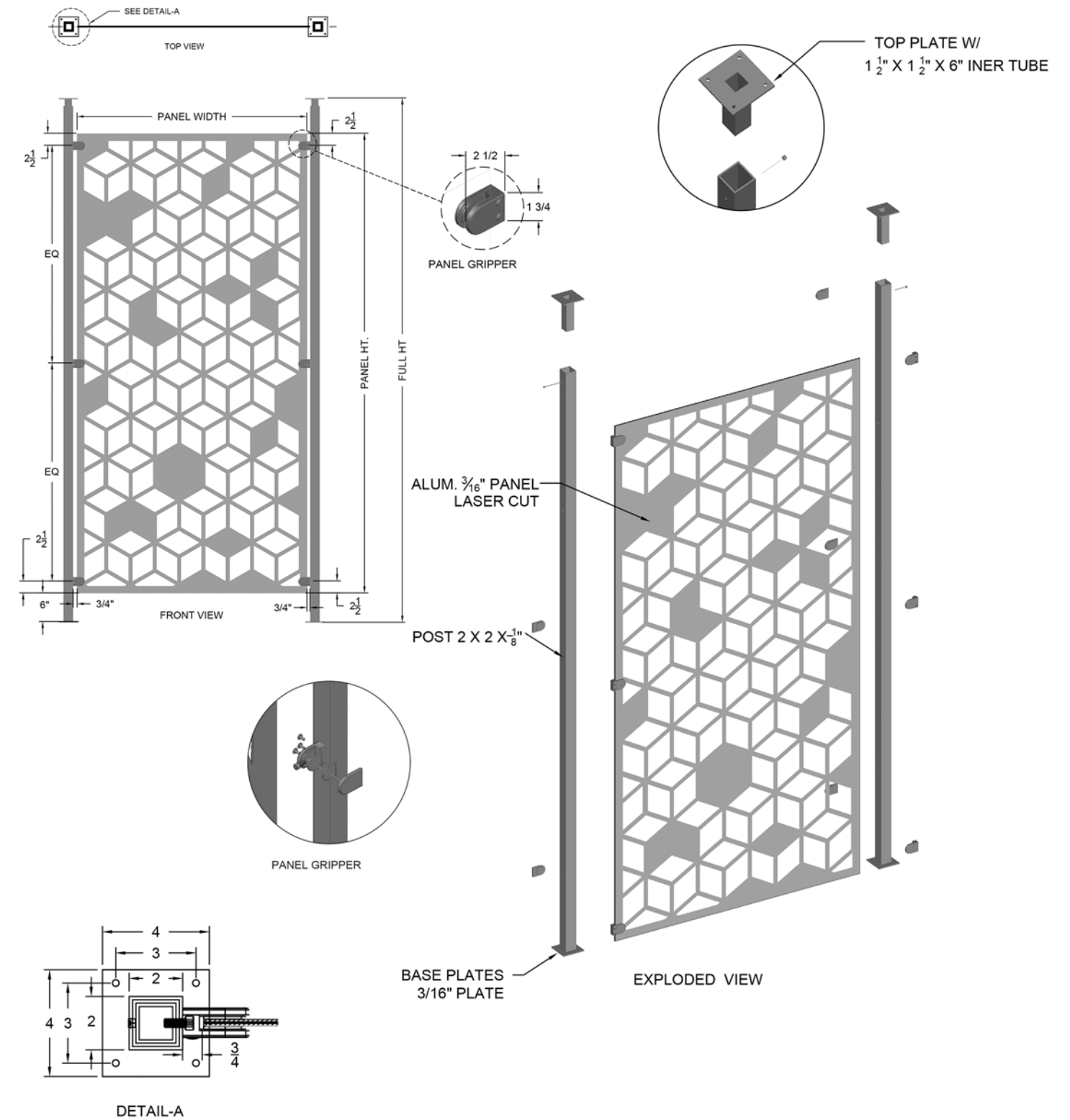
**Installation notes:**

Mounting substrate and fasteners to be provided by others.
For best performance, install on a straight, level surface.

VERTENZA TRILO

Posts with Grippers includes:

Preassembled three-layer panels, grippers, posts, and floor/ceiling mounting plates.

Panel Size:

4'x8' Standard size (max 4'x10')

Material options:

- Outer Layers: 1/8" Laser Cut or Perforated Aluminum (Laser cut panels must match)
- Inner Layer: 0.063" Perforated or Solid Aluminum (finished both sides)

Interior applications only



Mounting & Support:

Posts:

2" square aluminum posts in Brushed Clear finish with 4" square base plates (floor and ceiling).
Standard post height up to 12'.

Panel Grippers:

Brushed stainless finish, supports material up to 1/4" thick.
4' x 8' panels require 6 grippers.
4' x 10' panels require 8 grippers.

Custom options:

- Round post profile
- Painted posts and grippers in a complementary color
- Freestanding option available (some movement or flexibility expected).

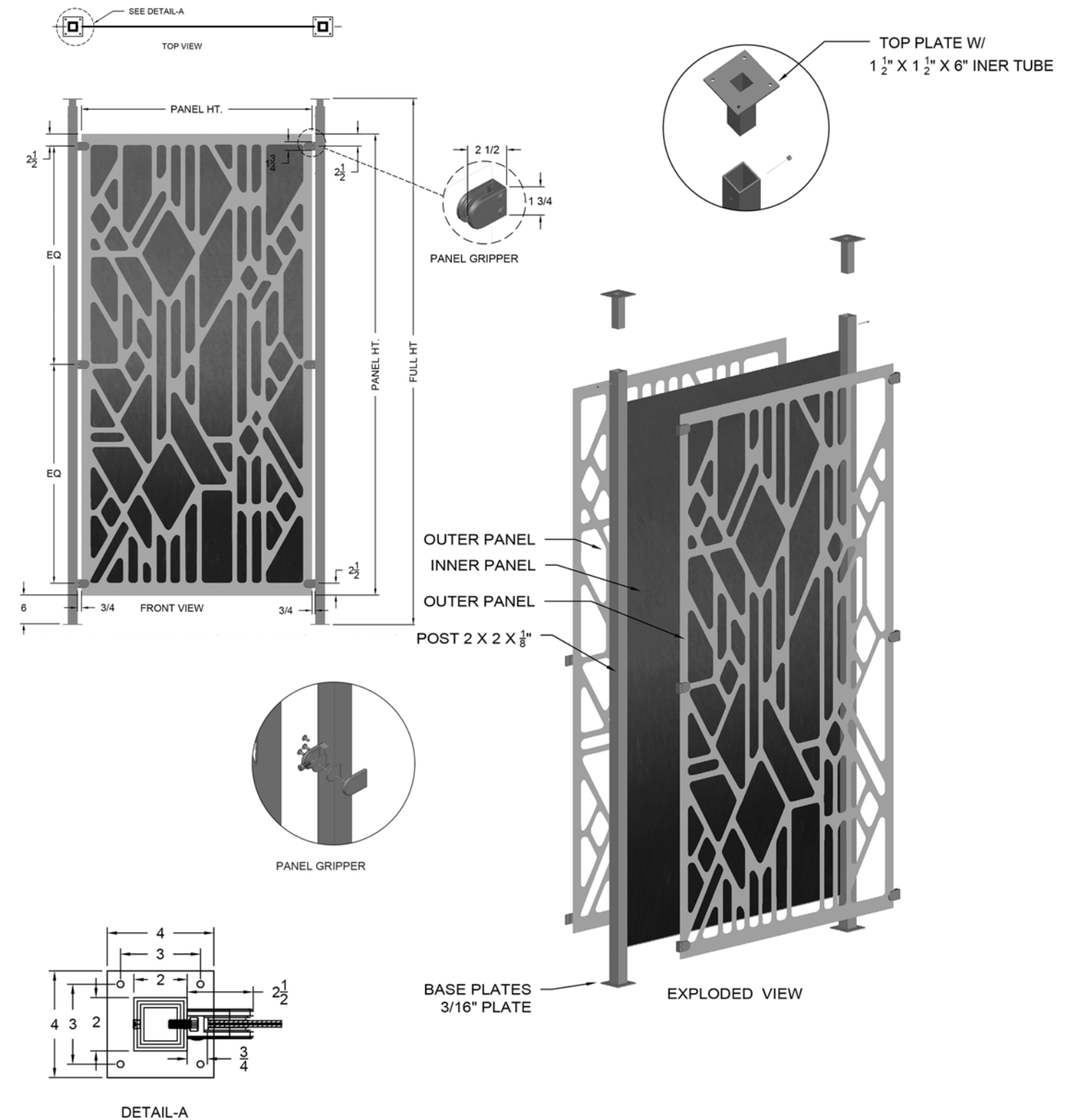

Installation notes:

The triple-layer panel assembly is heavier, and may require additional assistance for handling.
Mounting substrate and fasteners to be provided by others.
Ensure installation on a flat, even surface for best results.

VERTENZA DULO

Posts with Channel includes:

Two panels, posts with pre-mounted channels, panel fasteners, and floor/ceiling mounting plates.

Panel Size:

4'x8' Standard size (max 4'x10')

Material options:

- 3/16" Laser Cut Aluminum (Finished both sides)
- 1/8" Perforated Aluminum (with solid margins, finished both sides)
- .090" Solid Aluminum
- .090" Engravings Aluminum (single sided only)

Front and back panel materials may be the same or different. Panels can also be flipped or rotated for visual variation.

Suitable for interior & exterior applications

Mounting & Support:

Posts:

2" square aluminum posts in Brushed Clear finish with 4" square base plates (floor and ceiling). Standard post height up to 12'.

Channel Mounts:

Panels are mounted to full-height 1" x 1" U-channels with visible fasteners. (painted in a complementary color). Channels run the full height of the panels.

Custom options:

- Lighting Integration: Optional edge lighting at left and right sides.
- Freestanding option available (some movement or flexibility expected).



VERTENZA DULO

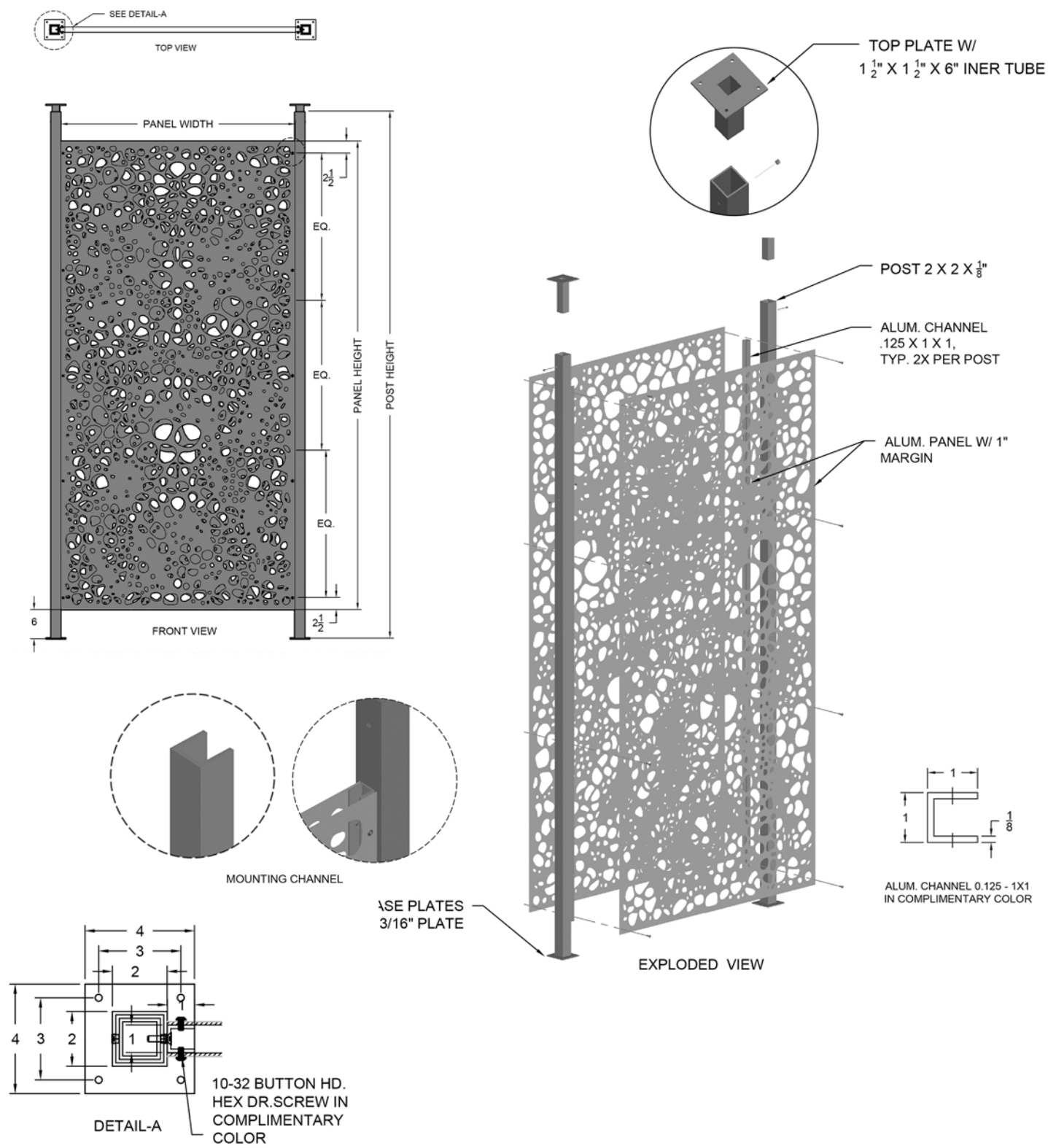

Installation notes:
Mounting substrate and fasteners to be provided by others.
Ensure installation on a straight, level surface for optimal stability.



VERTENZA ANGLE

Posts with Angle Mount includes:

Panels, posts with pre-affixed angle mounts, panel fasteners, and floor/ceiling mounting plates.

Panel Size:

4'x8' Standard size (*max 4'x10'*)

Material options:

3/16" Laser Cut Aluminum

1/8" Perforated Aluminum (*with solid margins*)

.090" Solid Aluminum

.090" Engravings Aluminum (*single sided only*)

Suitable for interior & exterior applications

Mounting & Support:**Posts:**

2" square aluminum posts in Brushed Clear finish with 4" square base plates (*floor and ceiling*). Standard post height up to 12'.

Angle Mounts:

Full-height angle affixed to the backside of panel.

(*Painted to match*)

Visible panel fasteners

(*painted in a complementary color*)

Supports up to 1/4" thick material.

Custom options:

- Posts and fasteners can be painted in a complementary color

- Freestanding option available (*some movement or flexibility expected*).

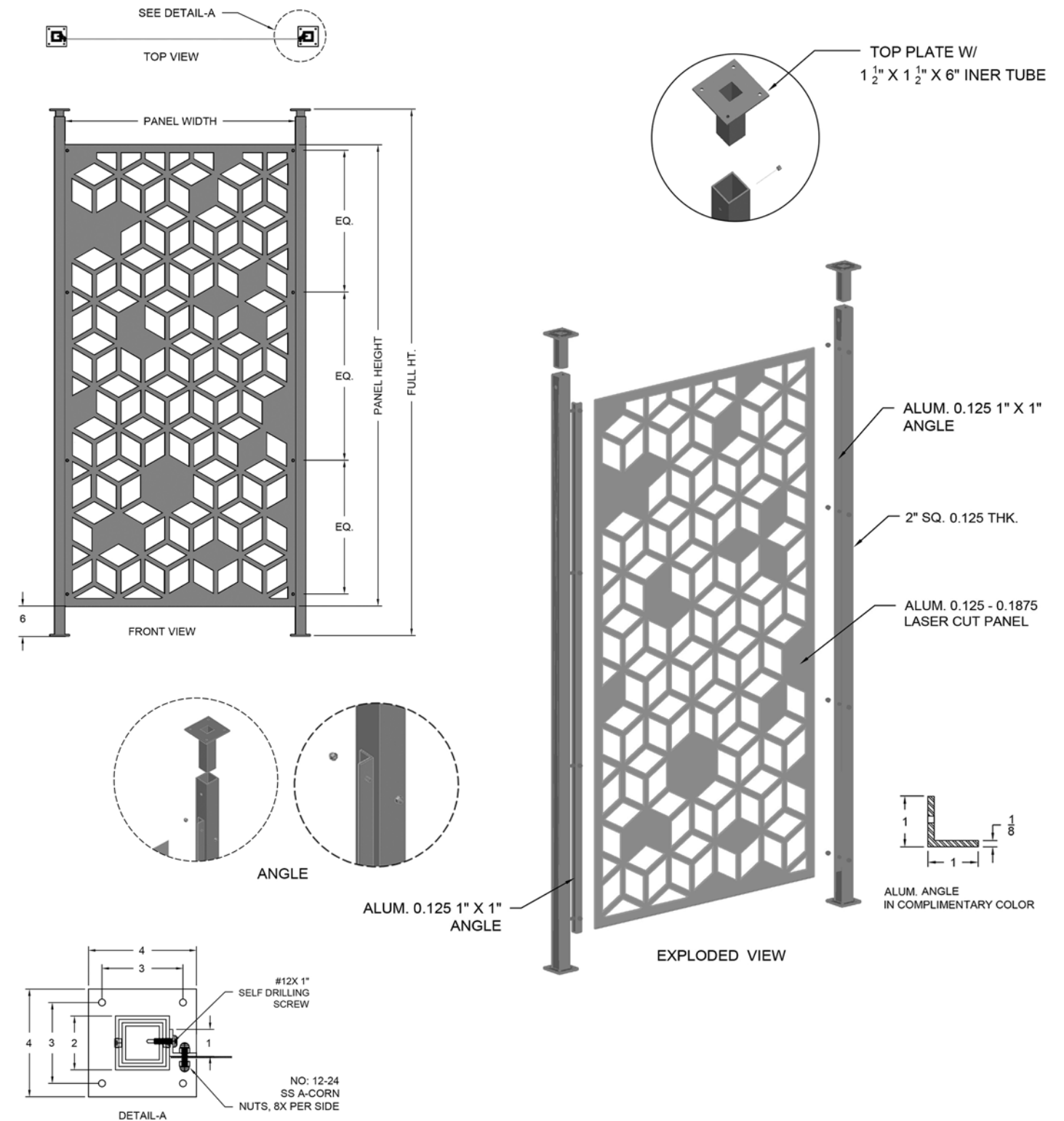

VERTENZA ANGLE

**Installation notes:**

Mounting substrate and fasteners provided by others.

For best stability, install on a straight, level surface.

VERTENZA DIRECT

Posts with Direct Mount includes:
Panels, posts, panel fasteners, and floor/ceiling mounting plates.

Panel Size:
4'x8' Standard size (max 4'x10')

Material options:
3/16" Laser Cut Aluminum
1/8" Perforated Aluminum (with solid margins)
.090" Solid Aluminum
.090" Engravings Aluminum (single sided only)

Suitable for interior & exterior applications

Mounting & Support:
Posts:
2" square aluminum posts in Brushed Clear finish with 4" square base plates (floor and ceiling).
Standard post height up to 12'.

Direct Mounting:
Panels fastened directly to posts
Minimal brushed stainless fasteners (painted in a complementary color)
Fastener placement: corners and every 24" on center
Supports up to 1/4" material

Custom options:
•Posts and fasteners can be painted in a complementary color
•Freestanding option available (some movement or flexibility expected).



VERTENZA DIRECT

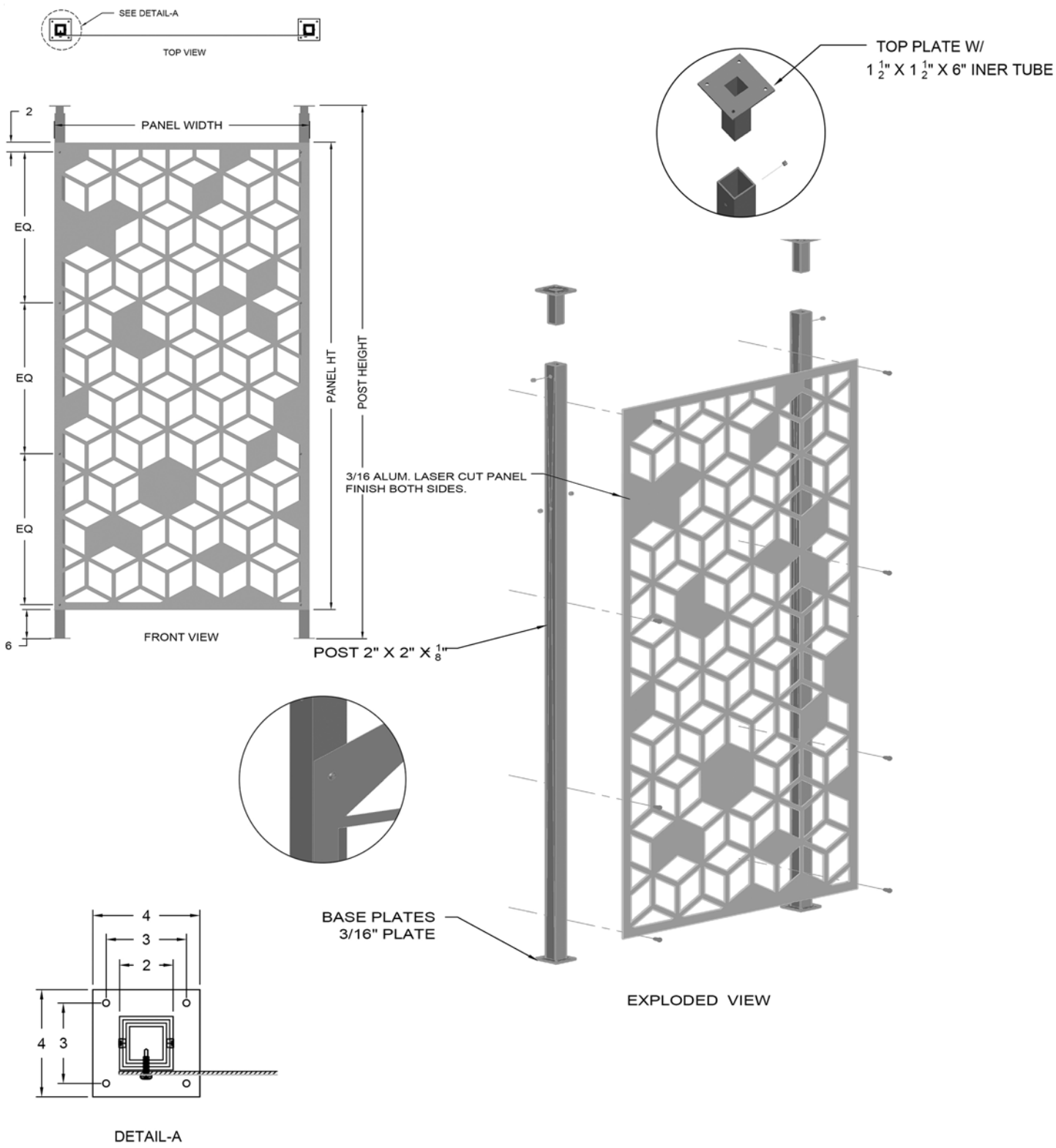

Installation notes:
Mounting substrate and fasteners provided by others.
Install on a flat, level surface for best stability.



Cables includes:

Panels, stainless steel cables, clear anodized grippers, and turnbuckles for floor-to-ceiling installation.

Panel Size:

4'x8' Standard size (max 4'x8')

Material options:

- 1/8" Laser Cut Aluminum
- 1/8" Perforated Aluminum (with solid margins)
- .090" Solid Aluminum
- .090" Engravings Aluminum (single sided only)

Suitable for interior & exterior applications



Mounting & Support:

Cables:

Stainless steel aircraft cables (max recommended height: 10')

Turnbuckles:

2-1/2" stainless steel, mounted floor/ceiling or top/bottom.

Grippers:

Clear anodized aluminum, holds up to 1/4" material
6 grippers required per 4' x 8' panel

Note: Cables, grippers, and turnbuckles not available in custom finishes.
Some movement is expected due to the flexible nature of the system.

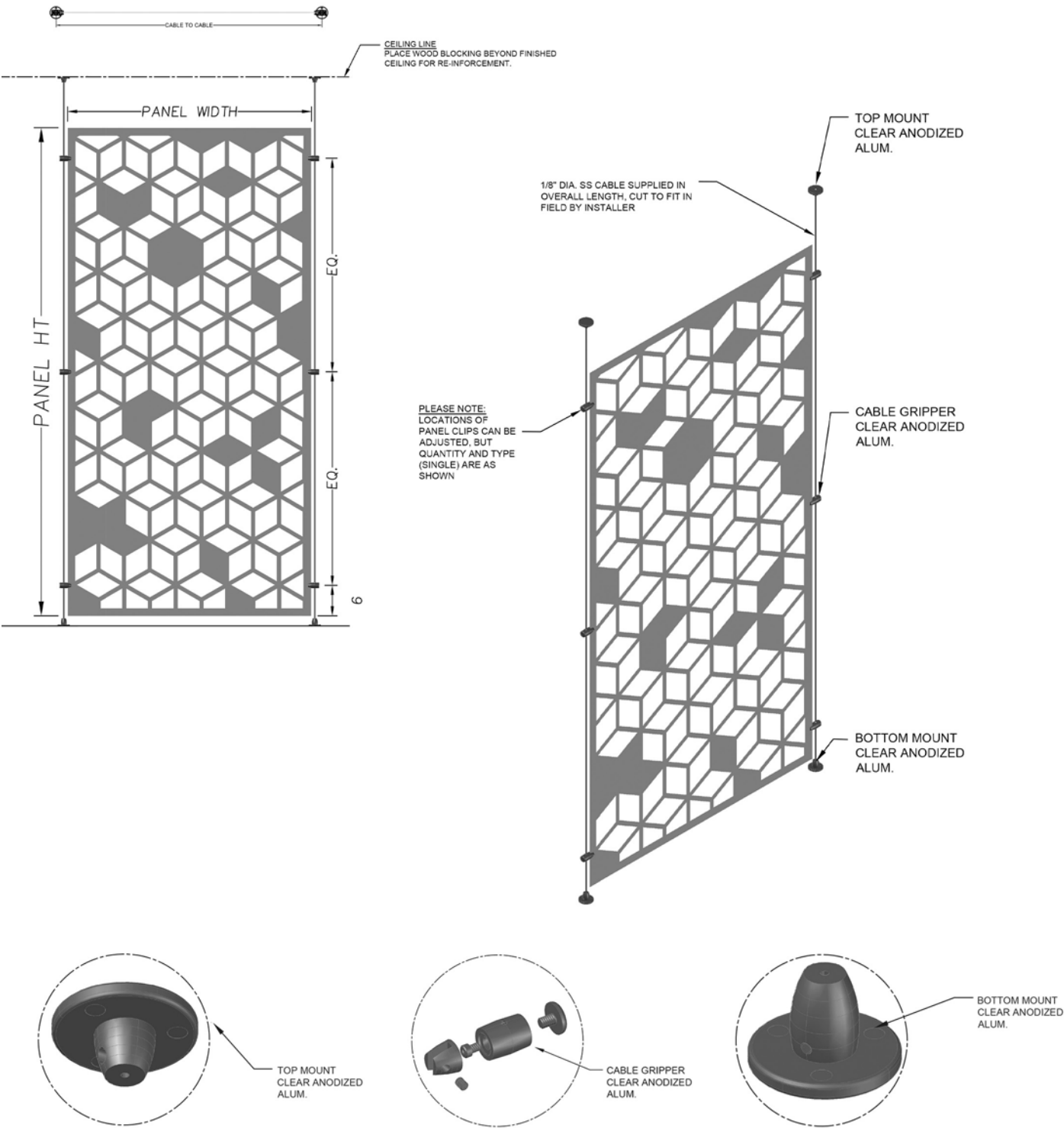

Installation notes:
Appropriate mounting substrate and backing to be provided by others.
For best results, install on a level, stable surface.

